

Proposed Project at Mouza- Santoshpur, J.L. No-22, Plot No-627, Khatian No-1068, Premises No-59, Hind Road, Ward No-104, Borough No-XI, under Kolkata Municipal Corporation, P.S.-Survey Park, Kolkata-700075

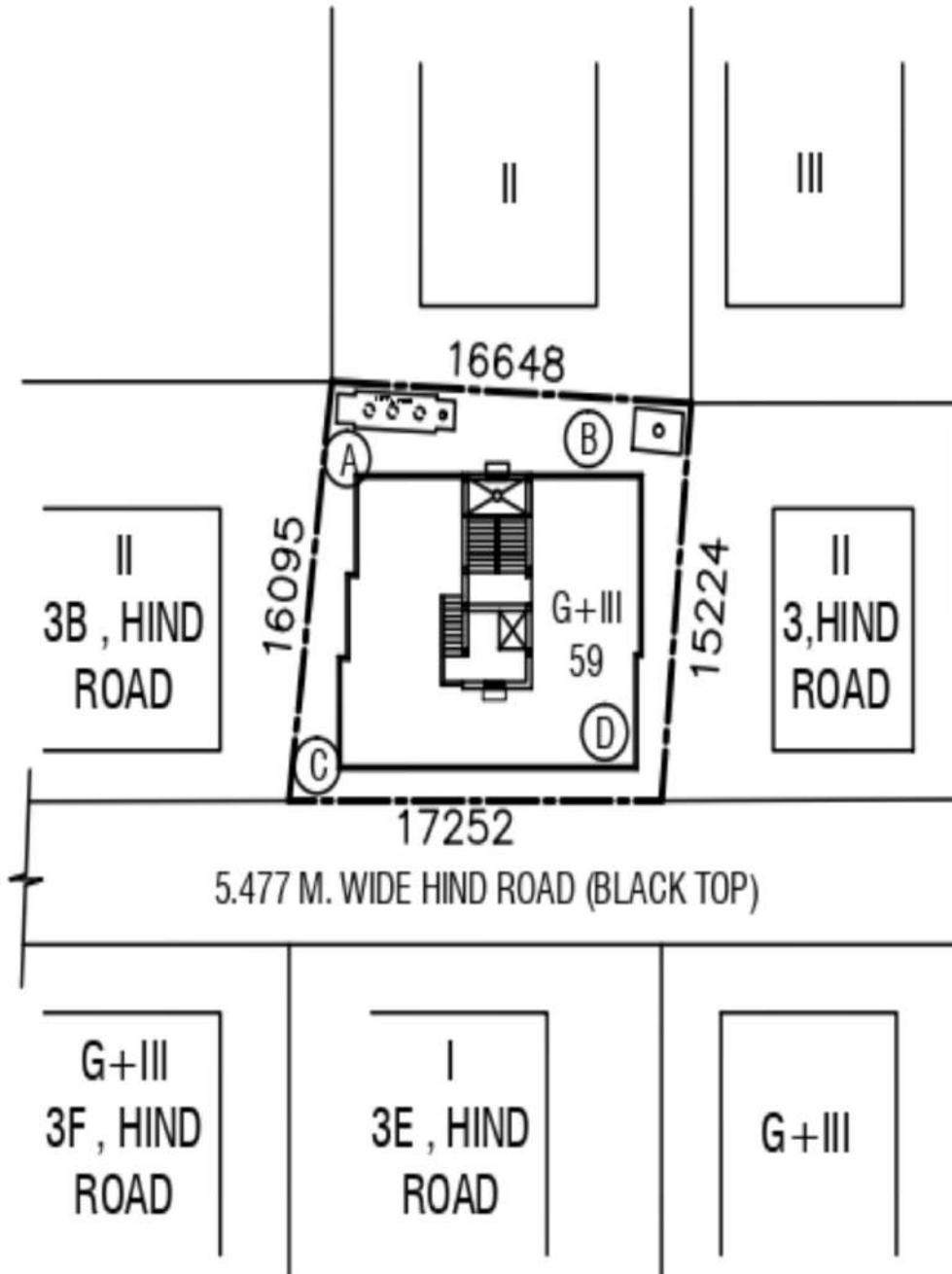

LATITUDE : 22.432665

LONGITUDE : 88.239191

FOR ASHIMA ENGINEERING
Purtha Prateek
Proprietor

SIGNATURE OF OWNER